

JINWOO SMC CO.,LTD.

Head Office / Gimje plant
 20, Baekgu Industrial Complex 1-gil, Baekgu-myeon,
 Gimje-City, Jeollabuk Province, R.O.K
 TEL : +82-63-770-7277 FAX : +82-63-770-7276
 website : www.jinwoosmc.com
 e-mail : jinwoosmc1@jinwoosmc.com
jinwoosmc4@jinwoosmc.com

Iksan Plant
 353, Sugam-Ro, Chunpo-Myun, Iksan City,
 Jeollabuk Province, R.O.K.
 Tel : +82-63-838-2529 Fax : +82-63-838-2527



JINWOO SMC **Fire Fighting Vehicle**



As a Global Enterprise JINWOOSMC is spreading throughout the world!

Established in 1992 as a Special Machineries company, we started to mass produce “Elevating Work Platforms” from 1998 as the country was focusing on reconstruction due to IMF crisis. Due to expansion in our products range, we established limited company “JINWOO SMC Co., Ltd.” in 2007. We started to produce various kinds of multi-purpose special machineries according to the technological trends in domestic as well as international markets.

Due to advancement of innovative high-end technologies in Korea, huge overseas demands for Korean products exist all-around the world. We started export in 2008 to Iraq ; followed by Middle-East, Asia in 2009 & mainly Canada, Philippines and Singapore in 2010. Thereafter ; to Iraq, Bangladesh, Iran, UAE, Vanuatu, Saudi Arabia, China, India since 2011. Then expanded export to Malaysia, Russia, Ghana in 2012 ; Peru, Indonesia, Vietnam in 2013 ; Kuwait, Uzbekistan, Turkmenistan in 2014 ; Thailand, Sri Lanka, Qatar in 2015, and since then we have been exporting to these countries.

Especially we developed Demolition Water Cannon Fire-fighting vehicle for first time in Korea in 2015, since then 14 units are delivered by successful bid to the Korean government - “Ministry of Public Safety and Security” as well “National 119 Rescue Headquarters”. Hence, we set-up mass production, special design and testing centers in newly established Head-office in 2020. So we set up mass production system, and presently participating in global tenders.

History

- | | | | | | |
|------|----|--|------|----|--|
| 1998 | 12 | Jinwoo Machinery was established. | 2014 | 12 | Developed High (Sky) Lander |
| 2007 | 10 | Jinwoo SMC Co., Ltd. was established. | 2015 | 06 | Acquired CE certificate |
| 2008 | 01 | The certificates of ISO9001/quality & ISO14001/ environmental were granted | 07 | 07 | Selection of the PHEV clean vehicles development projects |
| | 02 | Nominated as a venture business by Korean Government | 07 | 07 | Selection of the insulation aerial work platform(32m) development projects |
| | 06 | Developed aerial work platform of both 45M, 67M | 08 | 08 | Developed “Demolition Fire Apparatus” |
| | 11 | Aerial work platform of 40M was exported to Iraq | 12 | 12 | Acquired KFI certificate |
| 2009 | 02 | Developed aerial work platform of 75M height | 2016 | 02 | Awarded Minister of Public Safety and Security |
| | 04 | Approved Certification by Korea Food and Drug Administration for Super Specialty Ergonomic Medical Bed ~ Govt. Sponsored Health Care Project | 07 | 07 | Selection of the National Safety robot technology development projects |
| | 05 | Approved manufacturing the refrigerating machine | 11 | 11 | Awarded Head of the Small and Medium Business Prime Minister |
| | 09 | Approved GMP(good manufacturing practice) for production of medical equipment and quality management. | 12 | 12 | Acquired KFI certificate(Demolition Fire Apparatus) |
| | 12 | Developed sterilizer for welfare medical device | 12 | 12 | Acquired EPC certificate (Excellent Performance Certification) |
| | 12 | Increased capital (KRW200,000,000.-) | 2017 | 03 | Certificate of Designation for an excellent company(Public Procurement service) |
| | 12 | Nominated as a Reliable and Promising Export SME by Govt. Authority | 05 | 05 | Certificate of Designation for an Excellent Inventions (Korean Intellectual Property Office) |
| 2010 | 01 | Established the exclusive Research and Development center | 06 | 06 | Certificate of Designation of Excellent Product (Public Procurement service) |
| | 11 | Awarded One Million Dollar’s Export Volume Performance by Korea Int’l Trade Association | 09 | 09 | Signed procurement unit price contract |
| | 12 | Nominated again as Reliable and Promising Export SME by Govt. Authority | 2018 | 04 | Receipt of Excellence award from Prime Minister for successful functioning of advanced Fire-Fighting vehicle |
| 2011 | 10 | Developed Aerial ladder lift truck(Model 250L) | 2019 | 04 | Development and certification of compact Fire-fighting vehicle of 20m height, on just 8.2tons GVW vehicle |
| | 12 | Nominated again as Reliable and Promising Export SME by Govt. Authority | 2019 | 04 | Successfully developed and tested compact light-weight 20m Boom Firefighter |
| 2012 | 03 | Acquired GOST certificate & started exporting | 2019 | 12 | Developed 52m(Jinwoo540) Working Height for sophisticated works |
| | 06 | R&D task was selected by the National Emergency Management Agency | 2020 | 01 | Succeeded to obtain KFI(Korea Fire Institute) Certification for Compact 20m Boom Firefighter |
| 2012 | 12 | Nominated again as a venture business by Korean Government agency | 04 | 04 | Successfully developed and tested compact 20m Boom Firefighter with Water-Tank |
| 2013 | 05 | Developed Breaker of 2Ton capacity | 09 | 09 | Acquired Performance Certification (EPC) for compact 20m Boom Firefighter |
| | 08 | Developed Mobile kitchen truck | 09 | 09 | Succeeded to obtain KFI(Korea Fire Institute) Certification for Compact 20m Boom Firefighter with Water-Tank |
| 2014 | 02 | Developed aerial work platform of 45M height / articulating type | | | |



Demolition and Rescue Fire-Fighting(DRFF) Vehicle

JWF 210A

In the event of unexpected fire in a special zone with highly inflammable structures like in Chemical/Cement Plants, Oil and Natural Gas reserves etc; first response is always key to control the fire and in such situation; our specially research-developed world's rare Wireless Remote Controlled DRFF will first penetrate the structure through special Demolisher and then auto-spray the mixture of chemical Foam with water through Nozzle by auto-controlled CAFS(Compressed Air Foam System). Safety of Firefighters, Public as well as damage to property can be highly minimized due to rapid reaction in using DRFF.

Advanced Direct Water Spray Automatic Converting System



Fire Demolition and Suppression



Main Functionalities Testing (Certified & Approved)



Demolition and Rescue Fire-Fighting(DRFF) Vehicle

JWF 210A



Product Assembly Drawing / Maximum Working Area

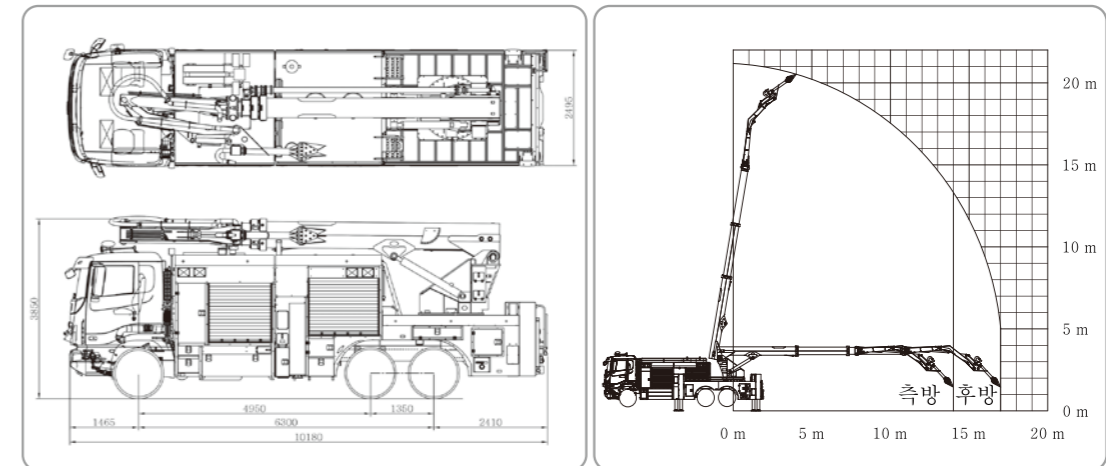

Main specifications

Overall Length / Height / Width	10,180 / 3,850 / 2,495 mm
Overall Weight (Configuration/GVW)	26,1400 Kg (6x4 / 28,100 Kg)
Water Spraying Demolisher Reach	21 m
Water Spraying Reach (Nozzle / Jet)	25,5 m / 80 m
Piercing Nozzle flow rate	4,500 ℓ /min
Power of demolition	Steel Plate(4 mm), Concrete(160 mm)
Fire Pump	5,300 ℓ /min
Water tank	2,000 ℓ
Foam tank (If CAFS provided)	400 ℓ
Outrigger	H - H Type (Single Push Auto leveling)
Extended width of Outrigger	5,200 mm (Extended 6,500)
Main Boom	Max. Angle 80 ° (Auto-stop)
Articulating Boom rotation	110 ° (Left / Right)
Turn-table rotation	Continuous
Lifting capacity	Rear(1Ton) / Side(0.5Ton) / Closed condition(1.5Ton)
Control Systems	Hydraulic, Mechatronic(using Wireless Remote Control) Auxiliary Engine, Automatic Stowage(One-Push button)
CAF System	Available (Optional)
Direct Water Spraying (Jet~Nozzle)	Automatic switching



Key Features highlights

- Firefighter personals safety is enhanced through Wireless Remote Controlled(WRC) operations allowing mobility and rapid reaction to ground situations.
- Enhances safety from collapse or explosion risk when fighting highly combustible zones in larger SEZs, buildings or distribution warehouses
- Delivers highly efficient and rapid fire suppression by penetrating the roof and wall of various types of buildings(excluding Thick Concrete-mixed walls).
- Provision for different types of Electrical and Hydraulic attachments allows rapid, clearing of Debris including vehicles as well versatile rescue works..
- Faster response to reach complex narrow fire originated spot.

Firefighting Operations Highlights



Chemical Plant



Historical Wooden structures
buildings/monuments



Oil Refineries and Storage sectors



Complex structures/buildings

Special Features



Tri-Axial Articulated
Boom movement



Auxiliary Emergency Engine



Automatic Self-defense
Spray system



Compressed Air Foam System

Compact Boom Fire-Fighting Vehicle (3.5 ton)

JWF 200LS

Most compact(8.5tons) Boom Firefighting vehicle capable of reaching complex location through narrow passage where existing medium to large fire trucks cannot reach. Its Design-tested in market with least maintenance and service requirements due to minimal Mechatronic system and Chain system in 16 edged Booms for life-long operations without replacements.

Automatic Spray conversion system



Rescue Platform rated capacity (400 Kg)



Narrow Operating radius

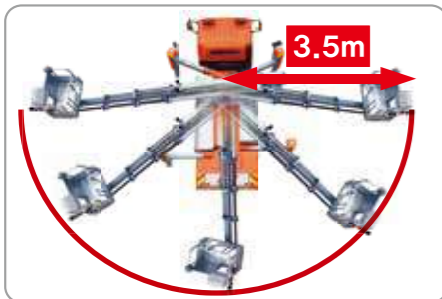

Safety Key Features



Emergency Auxiliary Engine



Rotation and Encoder detection



Automatic Self-defense Spray system



Rescue Platform Control Unit



Outrigger Jack detection sensor and Safety Check-Valve



Automatic Leveling Visual Indicator



Outrigger level Warning Indicator



Master Central Control System



Compact Boom Fire-Fighting Vehicle (3.5 ton)

JWF 200LS



Product Assembly Drawing / Maximum Working Area

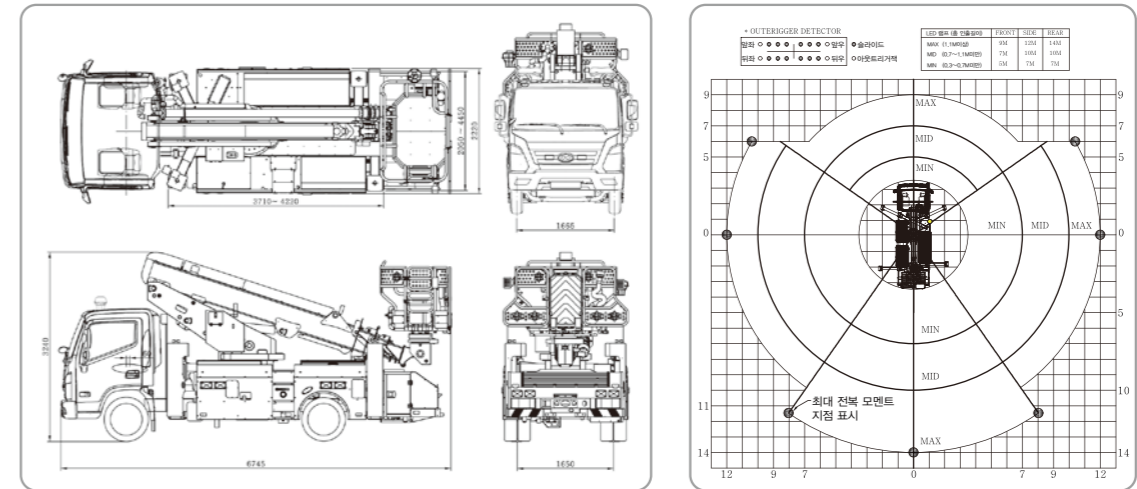

Main Specifications

Overall Length / Height / Width	6,745 / 2,220 / 3,240 mm
Overall Weight (Configuration/GVW)	8,050 Kg (4x2 / 8,200 Kg)
Rescue Platform payload capacity	400 Kg
Rescue Reach Height	20 m
Automatic Water Turret	700 GPM (Spray <-> Jet Auto change)
Rescue Platform	1,070 x 1,560 x 1,100 mm
Rescue Platform rotation	360 ° (Limited)
Boom	Interlock 4-step Telescopic (Chains connected)
Turn-Table rotation	360 ° Continuous (Max. 720deg.)
Outrigger	X - H Type (Auto leveling option)
Extended width of Outrigger	4,450 mm
Rescue Platform Control System	Electronic as well Portable Wireless Remote Control



Key Features highlights

- 360deg. Continuous rotation of Rescue Platform for easier maneuvering and positioning of Rescue platform for faster efficient life saving.
- Rescue Platform located at the rear allows faster rescue operations in constrained space.
- Maximum outreach is possible by avoiding obstacles at height as Rescue Platform can move upwards in narrow space

Application field

- Faster reach to Multi-use facilities and traditional markets with complex passage and space.
- Rapid access to Multiple complex and buildings of less than 7 floors wherein medium to heavy high-raise Firefighters cannot enter. Older Downtown areas in crowded space—constrained shopping areas and market clusters having narrow approach space.



Replace Low height reach



Reach constrained heights



Bee hive removal



Repair/replacing of frozen pipes

Rescue Platform 360 deg. Rotation

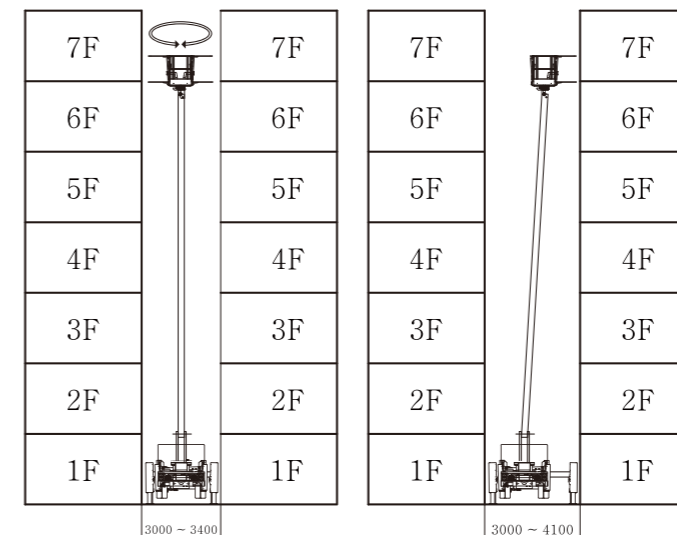

Compact Boom Fire-Fighting Vehicle (5 ton)

JWF 200PLS

It's a multipurpose Firefighting vehicle equipped with water pump and tank to simultaneously extinguish fire and perform rescue operations. It has excellent mobility in case of complex 7floor building located in a downtown area with narrow constrained passage. Multipurpose lifesaving Firefighting vehicle with enhanced rescue operations and firefighting efficiency.

Key Features

- Multipurpose compact Firefighter with maximum capacity of Water and Foam tanks
- Rapid approach to narrow roads in the city center and excellent maneuverability enable simultaneous fire suppression and rescue operations.
- Increased initial fire suppression capability through double supply and large capacity water tank
- Enhanced safety by applying automatic stowage type platform, automatically self-leveling, and easier entering into the Platform through secured rescue platform.
- Automatic warning Light in Rescue Platform visually indicates and warns of self-leveling status of the platform.
- Foldable type Rescue Platform allows easier driving as well smoother 360° (limited) rotation function to improve rescue efficiency.
- Rescue Platform rates Capacity: 400Kg.

Key Features



Compact Medium Weight vehicle



Double cabin



Rear Cabin for Rescue Personnel



Rear Warning Lights(LED)



Automatic Water-Turret attached



Automatic level status LED display



Auxiliary Emergency Engine



Special Sandwich PTO



Automatic water turret operations (Spray / Jet)



Side working



Rear working



Compact Boom Fire-Fighting Vehicle (5 ton)

JWF 200PLS



Product Assembly Drawing / Maximum Working Area

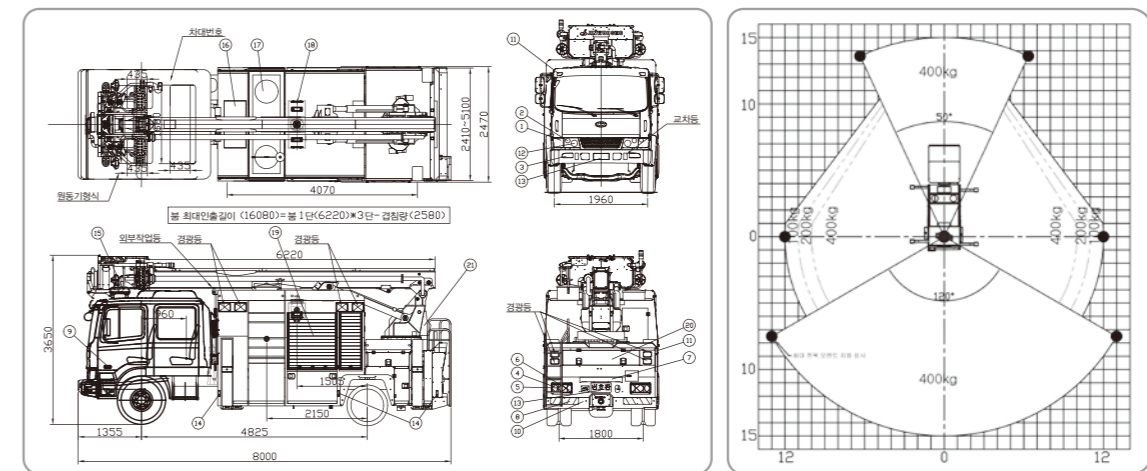

Main Specifications

Overall Length / Height / Width	8,000 / 3,650 / 2,480 mm
Overall Weight (Configuration/GVW)	8,050 Kg (4x2 / 8,200 Kg)
Rescue Platform capacity	400 Kg
Working Height	19.5 m
Working radius (max.)	15 m
Water tank	2,000 ℓ
Foam tank	100 ℓ
Automatic Water Turret	700 GPM (Spray <-> Jet Auto change)
Rescue Platform	620 x 1,670 x 1,000 mm
Boom	Interlock 3-step Telescopic(Chains connected)
Turn table rotation	360 ° Continuous (Max. 720deg.)
Outrigger	H - H Type (Auto leveling option)
Extended width of outrigger	5,100 mm
Rescue Platform Control System	Electronic as well Portable Wireless Remote Control

Key Features of Rescue Platform

- ◆ 360° rotation Rescue Platform (patented)
- ◆ Excellent workability and approach to, blind spots (narrow alley, corner area)
- ◆ 360° rotation allows access to all sides and corners of the building
- ◆ Excellent installation for flexible operations and easier approach minimizing movements
- ◆ Maximized working approach by rotating the rescue platform 360°



Spacious Recue Platform (Max. 400Kg)

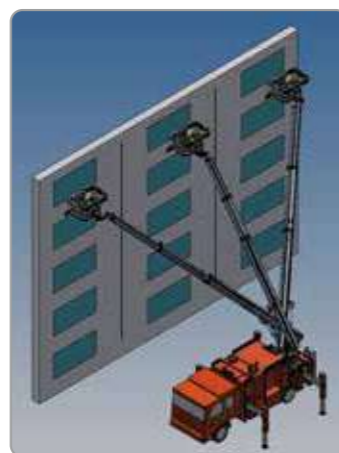

One position, wider reach



Master Central Control Station



Electrically driven Armored Robot Fire Truck (6 tons)

JWF 021EAR

In the event of a large-scale disaster takes place in large building or industrial plant facility such as hazardous gas leakage, structure collapse, explosion, etc.; fire extinguishing and rescuing are possible in situations where firefighting personnel approach is impossible. This Electric Armored Robot Firefighter is equipped with a robotic arm which can demolish the obstructions and pass through the debris, especially in disaster sites during catastrophic events such as Earthquake, Typhoon, Tsunami, Building collapse etc.



Rescue operation provided with Ambulance bed.



Direct Water Spray or Jet Nozzle auto switching



Positive Pressure Equipment.



High density smoke visibility



Automatic Water cannot and rescue attachments



Control Cockpit



Rescue Patient bed



Electric Battery

Product Assembly Drawing

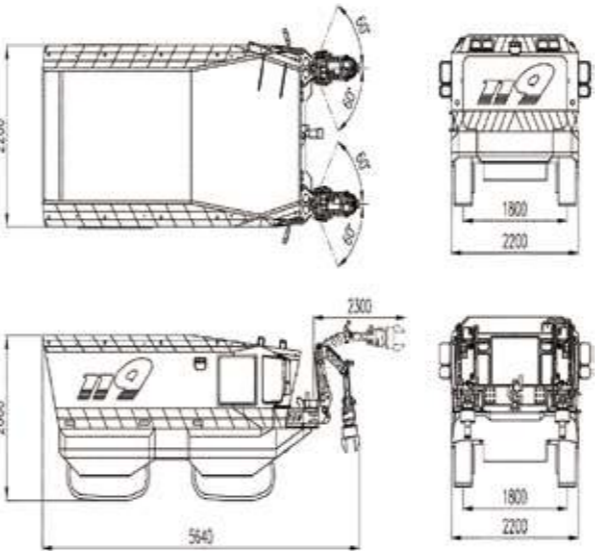

Main Specifications

Overall Length / Height / Width	5,640 / 2,000 / 2,000 mm
Max. Occupancy	4 personnel
In-cab air purifying capacity	5 m3/min
Max speed in non-slope pathways	10 km/h
Max. Climbing Angle	35 / 10 °
Safe Climbing Height	0.5 m
Turning radius	360 ° (Central)
Operating hour	1 hour
Thermal Resistance	500 °C
Extinguish Capacity	900 l/min
Robotic Arm shock grade	39.5 grade
Robotic Arm gravity	500 Kg · f
Performance parameters	3-Axial versatile multiple hydraulics Attachments (5 types)



Miniature Electric-driven Fire Engine (0.8 ton)

JWF 013ECL

Eco-friendly ultra-compact Electric battery driven compact Fire vehicle that is suitable for fire prevention patrols without fumes that can quickly respond to fires in narrow paths in; old towns where access is difficult, near schools, underground parking lots, Islands, remote areas etc.

Key Features

- Equipped with special module for fire suppression
- Fire hose automatic type reel device installed in sliding-type shelf structure.
- Vehicle safety devices such as ABS, rear camera, power steering, airbag, etc. provided.
- Electronic shifting option provided.
- High-strength/ultra-light base frame provided to strengthen robustness of the product.



Product Assembly Drawing

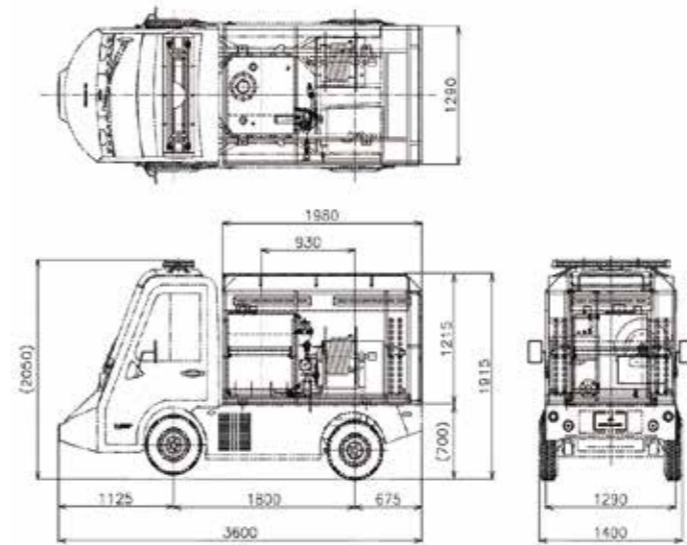

Main Specifications

Overall Length / Height / Width	3,600 / 1,915 / 1,400 mm
Max occupancy	2 persons
Max Speed	80 Km/h
Climbing ability	25 %
Charging time to full SOC	6 ~ 8 hour
Battery capacity	13 kwh
Motor Output	15 kw
Suspension type	Wishbone / Torsion beam
Water tank / Foam tank	302.9 / 20.5 l
Firefighting pump flow rate	650 @ 0.5 l/min @MPa 400 @ 0.7 l/min @MPa
Firefighting pump output	8.6

