



www.yjflex.com

FLEXIBLE SPRINKLER HOSE WITH FITTINGS & SPRINKLERS

YOUNGJIN
FLEX



The logo of Youngjin Flex Co., Ltd. is designed to show delicate sensibility of technical engineering and a symbol of piping, the core product. It represents the company's commitment to global business as a distinctive image.

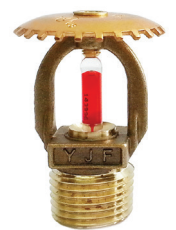
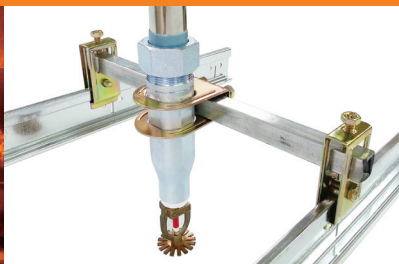

PRESIDENT GREETINGS

First, I'd like to express my deepest gratitude of the love shown by our loyal partners and customers.

Since our establishment in 1991, we have proved that our perseverance and customer-first service of many years have effectively kept up with the energetic development of plant industry of Korea, especially in the area of construction equipment and materials, and environment oriented plants (noise and vibration), as manifested by the growing number of our loyal customers.

The success, I am proud to say, is mainly based on our commitment to deliver our promise for quality products and to fulfill requirements and needs of our customers.

Thanks to our market-proven technological knowhow, experience and bold investment to keep our automation system always updated and optimally functioning.

We won not only the praises of customers but their hearts as a loyal customer by providing them with high quality and reliable industrial equipment such as bellows, flexible joints and water hammer cushion. FM, UL, LPCB, VdS, CNBOP, KS, ISO 9001/14001 are the example of our quality and standard achievement.

In the market section, we always stepped up our efforts to stay closer to our customers. We have a branch in the US, and a factory in Vietnam. YoungJin's sprinklers and flexible sprinkler hoses are installed for fire protection, in more than 30 countries such as USA, India, Belgium, UAE, and so on.

Our flagship products are widely used by a number of large construction companies such as Samsung, Daewoo, Hyundai, Lotte and GS.

As an industrial equipment manufacturer of quality products with a vision for future, YoungJin Flex will continue to commit itself to playing a significant role in advancement of construction industry.

Each of our staff will do our best to meet our customer's need and requirements in every aspect of quality, price and delivery requirements.

Thank you!

President **Lim Tea Koung**

HISTORY

-
- 2018** **12** Won Prize for "Top of Export - \$10 million"
- Korea International Trade Association (KITA)
- 06** Acquired ISO9001:2015, ISO14001:2015
- 03** Achieving FM Certification (Flexible Sprinkler Hose for Clean room)
-
- 2016** **11** Acquired CNBOP Certification
(Braided & Unbraided Type of Flexible Sprinkler Hoses)
-
- 2014** **10** Acquired LPCB Certification
(Braided & Unbraided Type of Flexible Sprinkler Hoses)
-
- 2013** **07** Acquired VdS Certification (Braided Type of Flexible Sprinkler Hoses)
- 06** Opened USA branch
-
- 2012** **12** Acquired Korea Certification Mark
- 08** Acquired ISO14001:2004
-
- 2011** **09** Established Vietnam Factory
- 05** Acquired UL Certification (Braided Type of Flexible Sprinkler Hoses)
-
- 2010** **07** Acquired FM Certification (Braided Type of Flexible Sprinkler Hoses)
-
- 2009** **10** Acquired UL Certification
(Braided & Unbraided Type of Flexible Sprinkler Hoses)
-
- 2008** **02** Registered vendor for Samsung semi-conductor (USA)
-
- 2007** **08** Promising Exporter awarded by Gyeonggi-do Governor
Registered vendor for Hynix Semi-conductor (Korea)
- 06** Registered vendor for Hynix Semi-conductor (China)
-
- 2006** **04** Started Selling Forged Valves
- 03** Affiliated R&D center
-
- 2001** **11** Acquired KS Certification (Expansion Joint) and ISO 9001:2000
-
- 1991** **11** Established YoungJin Flex Co., Ltd.
-



CONTENTS

	President Greetings	03
	History	04
01.	Flexible Sprinkler Hose with Fittings	06
02.	Sprinklers - Glass Bulb Type	10
03.	Sprinklers - Flush Type	12
04.	Sprinklers - Side Wall Type	13
05.	Sprinklers - Dry Pendent Type	14
06.	Sight Glass Union	15
	Installation Instructions	16
	Accessories	17

01

FLEXIBLE SPRINKLER HOSE WITH FITTINGS

GENERAL DESCRIPTION

Youngjin Flex Flexible Sprinkler Hose with Fittings is an easy-to-install sprinkler drop assembly comprised with branch line adapter nipple, no corrosive stainless steel flexible hose with nuts on each end, sprinkler reducer that connected to sprinkler head and ceiling bracket assembly that securely holds the sprinkler drop system to the ceiling grid.

The features and benefits of using Youngjin Flex Flexible Drop are easy-to-install, saving installation time and labor cost without any pipe threading, measuring and cutting, preventing any installation mistakes when following the proper installation instruction enclosed with flexible drops, and easier to test and charge the system with water before the ceiling grid is installed:

Increase installation efficiency by reducing labor cost and installation time. The rate of installation is two to three times faster than traditional fitting methods of installing sprinkler drops.

Increase efficiency in work flow by eliminating the traditional methods of installing sprinkler drops with no measuring and cutting. It is not necessary to use the traditional methods of installing sprinkler system, if an installer needs to adjust the level and alignment of sprinkler system and location. It is simply bended and maneuvered around ducts and trays in congested spaces.

No need of heavy or special equipments to install the flexible sprinkler drops and save the cost associated with installation by eliminating pipe wastage the waste comes from measuring, threading and cutting of pipes.

Easy-To-Install since flexible sprinkler drops come with fully assembled system of flexible sprinkler drops that connect from branch line to sprinkler head.

Corrosion-resistant materials by applying stainless steel 304 grade on flexible drops

Components Materials

- Flexible Hose : AISI 304 Stainless steel
- Braid (When Used) : AISI 304 Stainless Steel
- Nut : SWRM6K (Steel), Zinc plated
- Gasket Seal : NBR
- Isolation Ring : Nylon 6
- Reducers : SPP (Steel), Zinc plated
- Nipple : SPP (Steel), Zinc plated
- Brackets : SPGC (Steel), Zinc plated
- Support bar : SGCC (Steel), Zinc plated

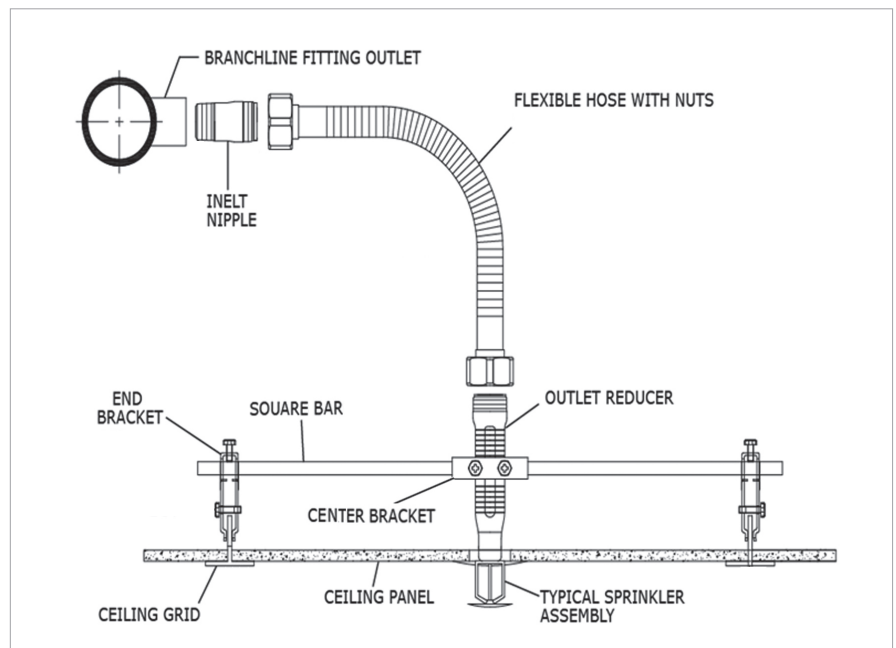



MODEL YJ27-S FLEXIBLE SPRINKLER HOSE

- Approvals : **UL**
- Inlet Connection (Nipple) : 1" NPT or BSPT
- Outlet Connections (Reducer) : 1/2", 3/4" NPT or BSPT
- Max. Working Pressure : 14kg/cm² (200psi)
- Max. Ambient Temperature : 150 °F
- Minimum Bend Radius : 5"

MODEL	LENGTH	OUTLET SIZE	E.Q.L SCHEDULE 40 PIPE, FEET	BENDING NO.
YJ27-S-700	700MM	1/2"	33	2
		3/4"	36	
YJ27-S-1000	1000MM	1/2"	65	3
		3/4"	59	
YJ27-S-1200	1200MM	1/2"	67	3
		3/4"	73	
YJ27-S-1500	1500MM	1/2"	84	3
		3/4"	77	
YJ27-S-1800	1800MM	1/2"	101	3
		3/4"	105	



MODEL YJ28-S FLEXIBLE SPRINKLER HOSE

- Approvals : **LPCB, CNBOP**
- Inlet Connection (Nipple) : 1" NPT or BSPT
- Outlet Connections (Reducer) : 1/2", 3/4" NPT or BSPT
- Max. Working Pressure : 14kg/cm² (200psi)
- Max. Ambient Temperature : 300 °F
- Minimum Bend Radius : 3"

MODEL	LENGTH	OUTLET SIZE	E.Q.L SCHEDULE 40 PIPE, METER		BENDING NO.
			LPCB	CNBOP	
YJ28-S-700	700MM	1/2"	2.6	4.2	1
YJ28-S-1000	1000MM	1/2"	4.9	5.9	1
YJ28-S-1200	1200MM	1/2"	6.1	6.7	2
YJ28-S-1500	1500MM	1/2"	10.8	11.4	2
YJ28-S-1800	1800MM	1/2"	12.7	13	3

01 FLEXIBLE SPRINKLER HOSE WITH FITTINGS



MODEL YJ27 - SB FLEXIBLE SPRINKLER HOSE

- Approvals : **UL, FM, VDS**
- Inlet Connection (Nipple) : 1" NPT or BSPT
- Outlet Connections (Reducer) : 1/2", 3/4" NPT or BSPT
- Max. Working Pressure : UL, FM, VDS - 14kg/cm² (200psi)
- Max. Ambient Temperature : UL-150 °F, FM, VDS -225 °F
- Minimum Bend Radius : UL, VDS - 5", FM – 11.8"

MODEL	LENGTH	OUTLET SIZE	E.Q.L SCHEDULE 40 PIPE, FEET		BENDING NO.	
			UL	FM	UL	FM
YJ27-SB-700	700MM	1/2"	33	33	2	1
		3/4"	36	28.3		
YJ27-SB-1000	1000MM	1/2"	65	43.6	3	2
		3/4"	59	48.1		
YJ27-SB-1200	1200MM	1/2"	67	55.9	3	3
		3/4"	73	86.8		
YJ27-SB-1500	1500MM	1/2"	87	67.5	3	4
		3/4"	77	111		
YJ27-SB-1800	1800MM	1/2"	101	78.8	3	4
		3/4"	105	120.8		



MODEL YJ28 - SB FLEXIBLE SPRINKLER HOSE

- Approvals : **FM, LPCB, VDS, CNBOP**
- Inlet Connection (Nipple) : 1" NPT or BSPT
- Outlet Connections (Reducer) : 1/2", 3/4" NPT or BSPT
- Max. Working Pressure : 14kg/cm² (200psi)
- Max. Ambient Temperature : 300 °F
- Minimum Bend Radius : FM-10", LPCB, VDS, CNBOP-3"

MODEL	LENGTH	OUTLET SIZE	E.Q.L SCHEDULE 40 PIPE, FEET (METER)			BENDING NO.	
			FM	LPCB	CNBOP	FM	LPCB, CNBOP
YJ28-SB-700	700MM	1/2"	15.6	(3.2)	(5)	1	1
		3/4"	13.8				
YJ28-SB-1000	1000MM	1/2"	27.3	(5.2)	(7.2)	2	1
		3/4"	25.8				
YJ28-SB-1200	1200MM	1/2"	35.1	(6.3)	(7.1)	3	2
		3/4"	33.8				
YJ28-SB-1500	1500MM	1/2"	46.8	(7.1)	(7.6)	4	2
		3/4"	45.8				
YJ28-SB-1800	1800MM	1/2"	58.7	(8.8)	(9.4)	4	3
		3/4"	57.8				



MODEL YJ32 - CR FLEXIBLE SPRINKLER HOSE

- Approvals : **FM**
- Inlet Connection (Nipple) : 1" NPT or BSPT
- Outlet Connections (Reducer) : 1/2", 3/4" NPT or BSPT
- Max. Working Pressure : 14kg/cm² (200psi)
- Max. Ambient Temperature : 225 °F
- Minimum Bend Radius : 8"

MODEL	LENGTH	OUTLET SIZE	E.Q.L SCHEDULE 40 PIPE, FEET	BENDING NO.
YJ32-CR-800	800MM	1/2"	18.4	2
		3/4"	14.8	
YJ32-CR-1000	1000MM	1/2"	24.9	2
		3/4"	20.4	
YJ32-CR-1200	1200MM	1/2"	31.4	3
		3/4"	25.9	
YJ32-CR-1500	1500MM	1/2"	41.1	4
		3/4"	34.3	
YJ32-CR-1800	1800MM	1/2"	50.8	4
		3/4"	42.6	

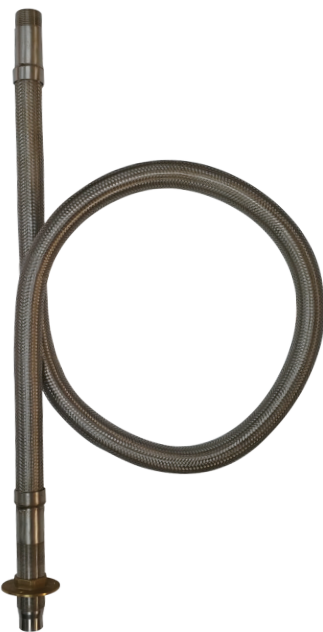

MODEL YJ32 - CM FLEXIBLE SPRINKLER HOSE

- Approvals : **FM**
- Inlet Connection (Nipple) : 1" NPT or BSPT
- Outlet Connections (Reducer) : 1/2", 3/4" NPT or BSPT
- Max. Working Pressure : 14kg/cm² (200psi)
- Max. Ambient Temperature : 225 °F
- Minimum Bend Radius : 8"

MODEL	LENGTH	OUTLET SIZE	E.Q.L SCHEDULE 40 PIPE, FEET	BENDING NO.
YJ32-CM-700	700MM	1/2"	12.7	2
		3/4"	13.8	
YJ32-CM-1000	1000MM	1/2"	20.1	2
		3/4"	21.2	
YJ32-CM-1200	1200MM	1/2"	25	3
		3/4"	26.1	
YJ32-CM-1500	1500MM	1/2"	32.3	4
		3/4"	33.5	
YJ32-CM-1800	1800MM	1/2"	39.6	4
		3/4"	40.9	

02

SPRINKLERS - GLASS BULB TYPE YJ-PS & YJ-US

Glass bulb actuated sprinklers are filled with a thermal expansion liquid that will expand and burst when the ambient temperature rises due to heat. Then fire-extinguishers water will be released & put out a fire.

YJ-PS : KFI

No.	Description	Material
1	Frame	Brass
2	Deflector	Brass
3	Bulb Cap	Brass
4	Glass Bulb	Glass

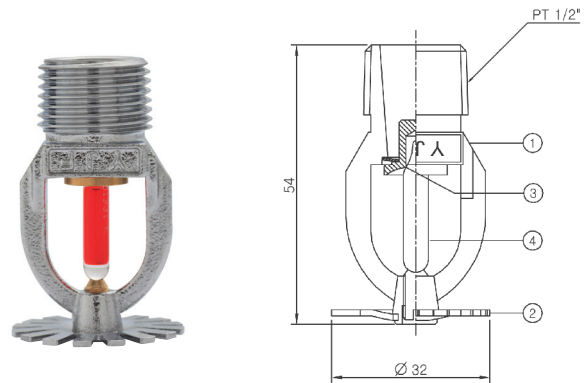

YJ-US : KFI

No.	Description	Material
1	Frame	Brass
2	Deflector	Brass
3	Bulb Cap	Brass
4	Glass Bulb	Glass

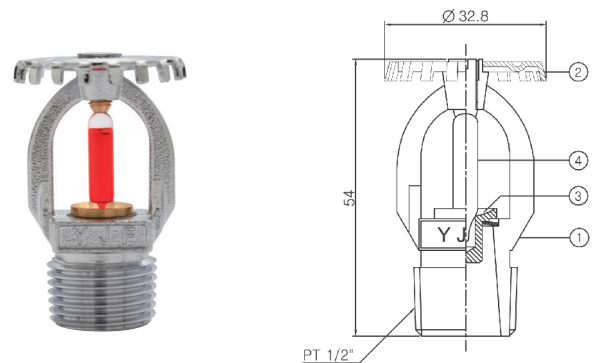

SPECIFICATION

Model No.	YJ-PS-1	YJ-PS-2	YJ-US-1	YJ-US-2
Working Temperature	68°C	93°C	68°C	93°C
Max Ambient Temperature	39°C	56°C	39°C	56°C
Temp , Indication color	Red	Green	Red	Green
Connection Screw Size	15A (PT1/2")			
Orifice Size	Ø11.2mm			
Flow Rate	80ℓ / min-0.1 MPa(K=80)			
Test Pressure	2.5MPa			
Surface Finishing	Ni-Cr Coating			

YJ-001 & YJ-002

YJ001-PS : UL

No.	Description	Material
1	Frame	Brass
2	Deflector	Brass
3	Bulb Cap	Brass
4	Glass Bulb	Glass

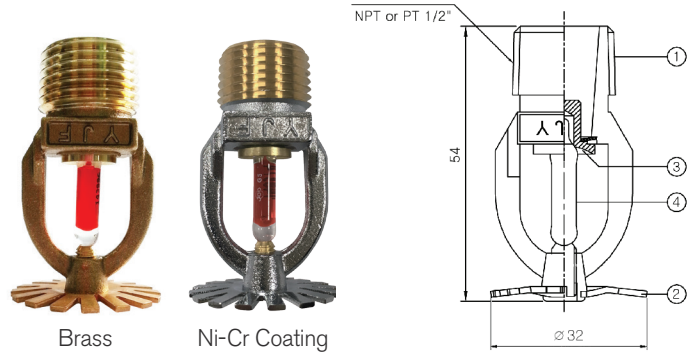

SPECIFICATION

Model No.	YJ001-PS-57	YJ001-PS-68	YJ001-PS-79	YJ001-PS-93	YJ001-PS-141
Working Temperature	57°C	68°C	79°C	93°C	141°C
Max Ambient Temperature	39°C	39°C	43 °C	56°C	99 °C
Response Time Index	81-350				
Connection Screw Size	15A (BSPT1 /2" or NPT1/2")				
Orifice Size	$\varnothing 11.2\text{mm}$				
Flow Rate	K=5.6				
Test Pressure	3.4MPa				

YJ002-US : UL

No.	Description	Material
1	Frame	Brass
2	Deflector	Brass
3	Bulb Cap	Brass
4	Glass Bulb	Glass

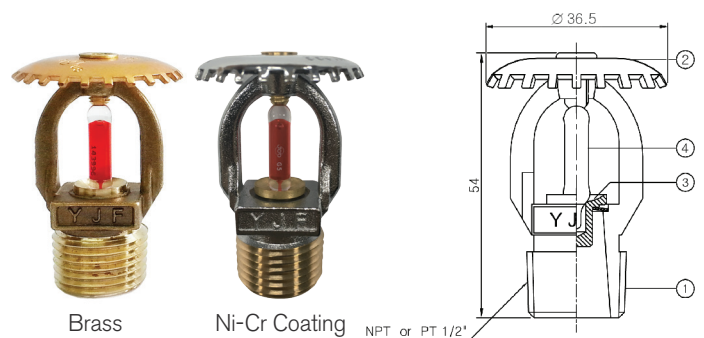

SPECIFICATION

Model No.	YJ002-US-57	YJ002-US-68	YJ002-US-79	YJ002-US-93	YJ002-US-141
Working Temperature	57°C	68°C	79°C	93°C	141°C
Max Ambient Temperature	39°C	39°C	43°C	56°C	99°C
Response Time Index	81-350				
Connection Screw Size	15A (BSPT1 /2" or NPT1/2")				
Orifice Size	$\varnothing 11.2\text{mm}$				
Flow Rate	K=5.6				
Test Pressure	3.4MPa				

03

SPRINKLERS- FLUSH TYPE YJ-FS & YJ-FQ

This Flush Type is designed for a compact and neat product that has the minimized protruding part. It's also made for extinguishing a fire in the early by the quick reaction speed of the heat detector.

YJ-FS : KFI

No.	Description	Material
1	Body	Brass
2	Frame	Brass
3	Deflector	Brass
4	Heat Collector	Copper

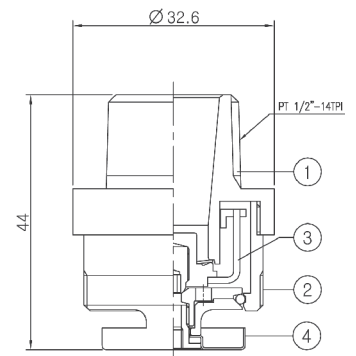

YJ-FQ : KFI

No.	Description	Material
1	Body	Brass
2	Frame	Brass
3	Deflector	Brass
4	Heat Collector	Copper

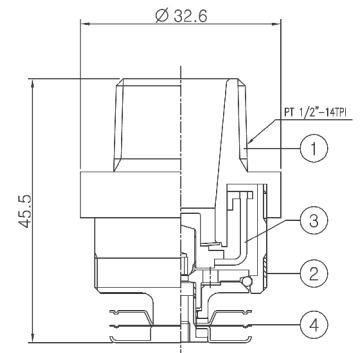

SPECIFICATION

Model No.	YJ-FS-1	YJ-FS-2	YJ-FQ-1	YJ-FQ-2
Working Temperature	72℃	105℃	72℃	105℃
Max Ambient Temperature	39℃	67℃	39℃	67℃
Response Time Index	81-350		Max 50	
Connection Screw Size	15A (PT 1/2")			
Orifice Size	Ø11.2mm			
Flow Rate	80ℓ / min-0.1 MPa(K=80)			
Test Pressure	2.5MPa			
Surface Finishing	Ni-Cr Coating			

04

SPRINKLERS - SIDE WALL TYPE

YJ-SW & YJ-SWQ

This Side Wall Type installed at the top of the wall, indoors, is allowed to water one side only. It is used in the mechanical parking station, on a fireproof shutter, hotel rooms, near the escalator, and more.

YJ-SW : KFI

No.	Description	Material
1	Frame	Brass
2	Deflector	Brass
3	Bulb Cap	Brass
4	Glass Bulb	Glass

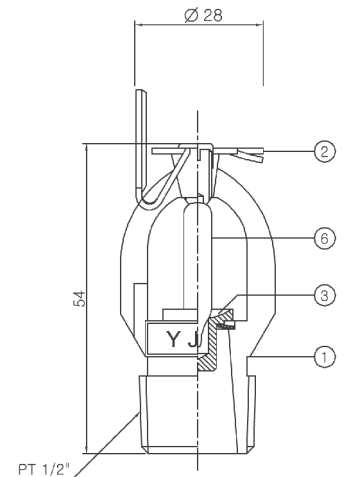

YJ-SWQ : KFI

No.	Description	Material
1	Frame	Brass
2	Deflector	Brass
3	Bulb Cap	Brass
4	Glass Bulb	Glass

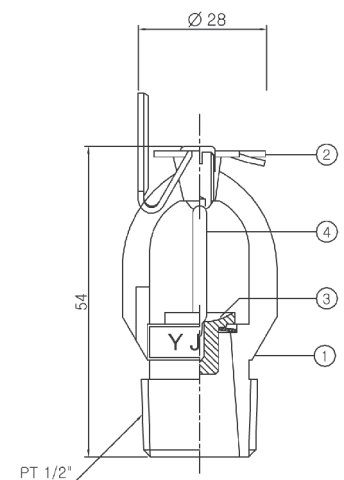

SPECIFICATION

Model No.	YJ-SW1	YJ-SW2	YJ-SWQ1	YJ-SWQ2
Working Temperature	68°C	93°C	68°C	93°C
Max Ambient Temperature	39°C	56°C	39°C	56°C
Temp , Indication color	Red	Green	Red	Green
Connection Screw Size	15A (PT 1")			
Orifice Size	Ø11.2mm			
Flow Rate	80ℓ / min-0.1 MPa(K=80)			
Test Pressure	2.5MPa			
Surface Finishing	Ni-Cr Coating			

05

SPRINKLERS - DRY PENDENT TYPE YJ-DP

This Dry Pendent Type is designed for protection of freezing & bursting in the cold regions, keeping flow fire-extinguishers spray water into the Dry Pendent.

YJ-DP : KFI

No.	Description	Material
1	Frame	Brass
2	Deflector	Brass
3	Glass Bulb	Glass
4	Tube Holder	Brass
5	Out Tube	Steel
6	Inlet Tube	Copper
7	Fitting Holder	Brass
8	Tube Cap	Brass
9	Plunger	Brass

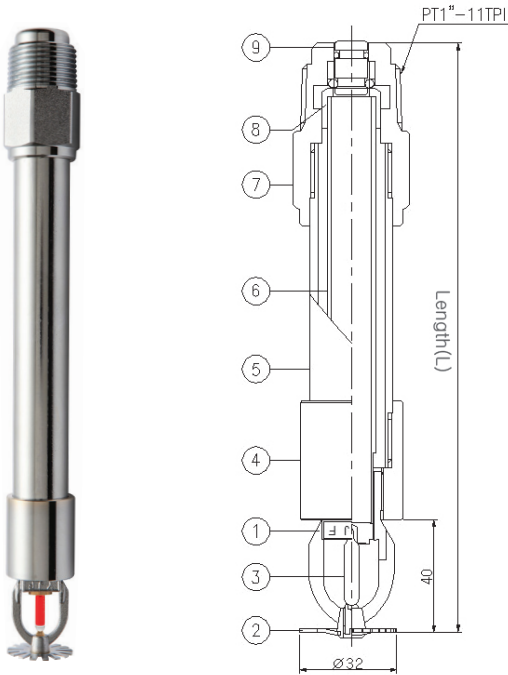

Model No.	YJ-DP 150	YJ-DP 300	YJ-DP 400	YJ-DP 450	YJ-DP 500	YJ-DP 600	YJ-DP 700
Length(L)	150	300	400	450	500	600	700

SPECIFICATION

Model No.	YJ-DP1	YJ-DP2
Working Temperature	68℃	93℃
Max Ambient Temperature	39℃	56℃
Temp, Indication color	Red	Green
Connection Screw Size	25A (PT 1")	
Orifice Size	Ø11.2mm	
Flow Rate	80ℓ / min-0.1 MPa(K=80)	
Test Pressure	2.5MPa	
Surface Finishing	Ni-Cr Coating	

06

SIGHT GLASS UNION TKSGU-25

Sight Glass Union is a conveniently usable product unifying test pipe, which is jointly set up at the end of sprinkler pipe, and Orifice sight glass. Therefore it can be set up in any places within installation part of pipe.



TKSQU-25

Features

- Orifice ($\varnothing 11.2$), Sight Glass, Unified type of Union (PT 1")
- Customers can see operation of sprinkler pipe.
- Customers can save union by alternating with Union connecting holes.
- Customers can conveniently maintain and install union with disassembling and connection function of union.
- It has size of PT1" matching with pipe standard for end of sprinkler pipe.
- Customers can save cost for auxiliary components.

SIGHT GLASS UNION INSTALLATION

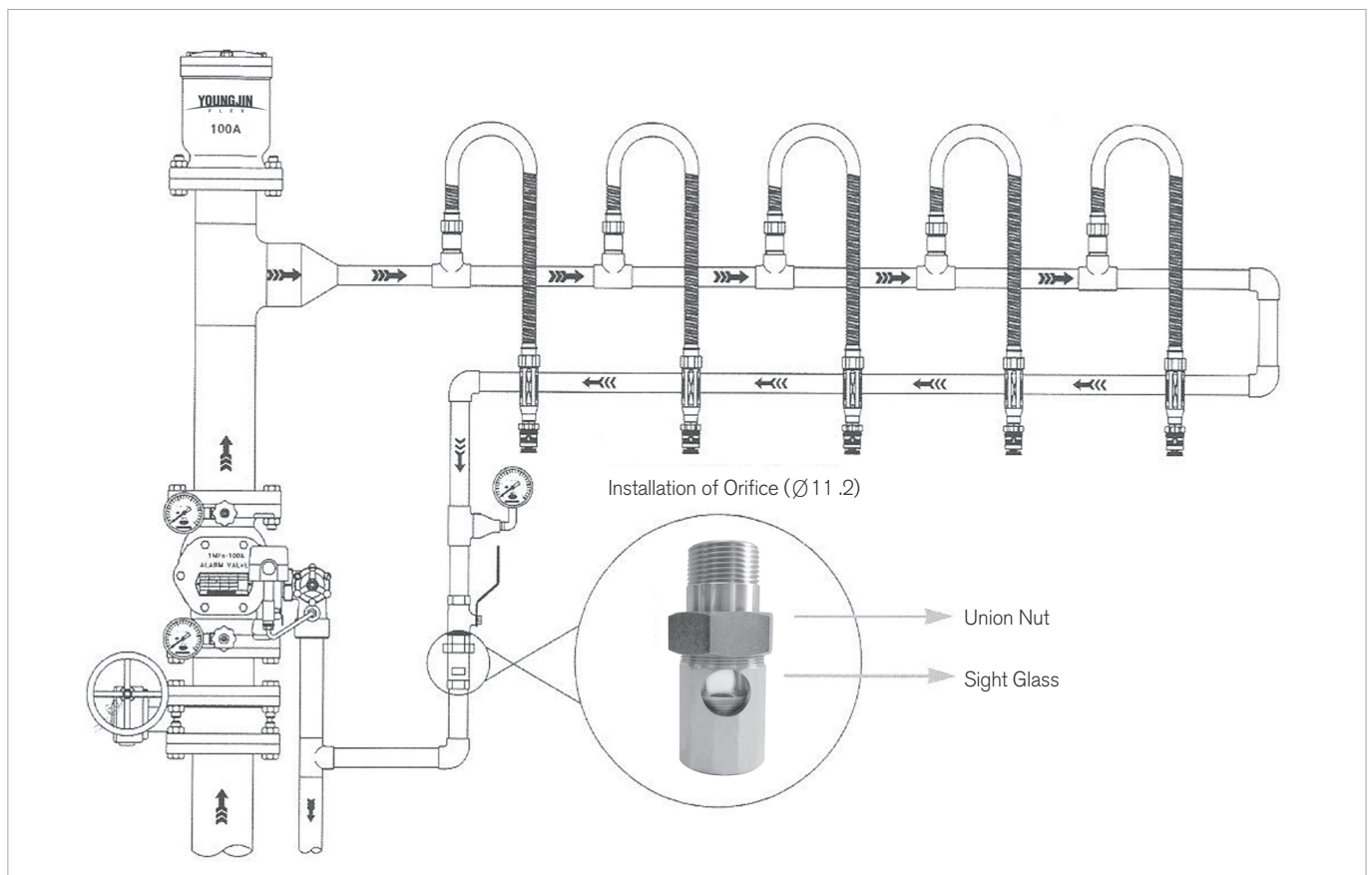

INSTALLATION INSTRUCTIONS



1. Do visual inspection to see if there is any sign of physical damage on the hose.
2. Check O-Ring and Insulation Ring to see if there is any sign of physical damage .
3. Connect Reducer to Nut by using a wrench .

* Nut and Reducer connecting torque: 500kgf/cm

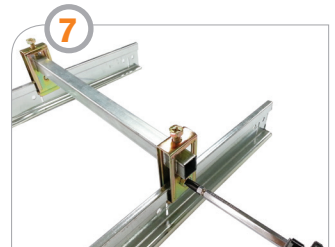

4. Apply Teflon tape on the inlet nipple thread. Use pipe wrench to connect the inlet nipple to the branch line.
5. After inspect O-Ring and Insulation Ring for any sign of physical damage, connect flexible sprinkler hose to the outer nipple.

⚠ Warning : Do NOT apply Teflon tape on the outer nipple thread when connect to the flexible sprinkler hose.

*Nipple+main pipe connecting torque : 850-900kgf/cm

*Nut +Nipple connecting torque : 500kgf/cm

6. Install each Bracket-S to Square bar by using drivers as shown on photo 6. Put a space of 600 mm to 1200mm approximately.
7. Connect square bar to the T-bar ceiling grid as shown on photo 2 and tighten the bolts on the Bracket-S to secure on the grid.

* Bracket-S bolts connecting torque : 45kgf/cm

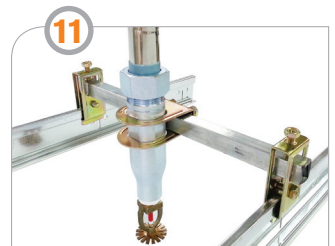
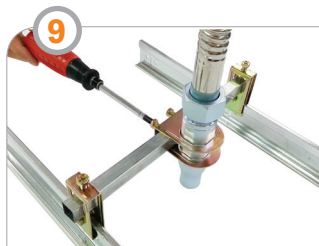
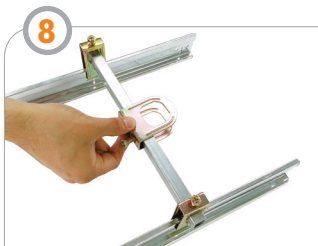

8. Place the Bracket-L at the middle of the square bar.
9. Insert the outlet reducer from the flexible sprinkler hose and securely fasten by tightening two bolts on the Bracket-L

* Bolts Of Bracket-L Connecting Torque : 65kgf/cm

10. Apply the Teflon tape on the inlet thread of sprinkler head and connect to the outer nipple of reducer.
11. Check all the parts are securely tightened.

ACCESSORIES



110mm / Standad Reducer
REGST 110



110mm / Reducer(Rolling)
REGST 110



135mm / Reducer(Rolling)
REGST 135



155mm / Reducer(Rolling)
REGST 155



110mm / Elbow Reducer
REN 90110



155mm / Elbow Reducer
REN 90155



150mm / Elbow Reducer
REN 90150



1" Nipple
NIBA 25



Connection Nipple
NIC025



1- 1/4" Nipple
NIBA 32



Center Bracket
CBBA



Center Bracket (Circle)
CBBAC



Short Side Bracket
SBBA60



Medium Side Bracke
SBBA78



Long Side Bracket
SBBA105



Short Hat Channel / Side Bracket
SBRD60



Long Hat Channe / Side Bracket
SBRD80



Metal Stud / Side Bracket
SBH038



53mm Metal Stud / Side Bracket
SBH053



Elbow Bracket
EBWE



Short Side Bracket
SBBA60(2B)



Long Side Bracket
SBBA110(2B)



Wood Beam / Side Bracket
SBWB



Bolt / Wing Bolt
BOBA/BOBF

BEST OF BEST

As an industrial equipment manufacturer of quality products with a vision for future, YoungJin Flex will continue to commit itself to playing a significant role in advancement of construction industry. Each of our staff will do our best to meet our customer's need and requirements in every aspect of quality, price and delivery requirements.





Jul.2019



YOUNGJIN FLEX Co.,Ltd

93, Dangjaebong-ro, Jori-eup,
Paju-si, Gyeonggi-do, South Korea

TEL. +82-31-432-9772

FAX. +82-31-947-9745

www.yjflex.com

