

Geothermal energy sytem

GeoSSum Hybrid 지오섬 하이브리드

GeoSSum Hybrid

Open loop geothermal system without groundwater motor pump

New Excellent Technology(south Korea)
Patent (south Korea)

Characteristics of GeoSSum Hybrid

- Application of prevent deposition-open-loop-geothermal heat exchanger
- Open loop geothermal system without groundwater motor pump
- Reduced construction costs by up to 50% (at Smart Farm)
- Prevent the inflow of pollutants
- Prevent the leakage of brain
- Easy maintenance

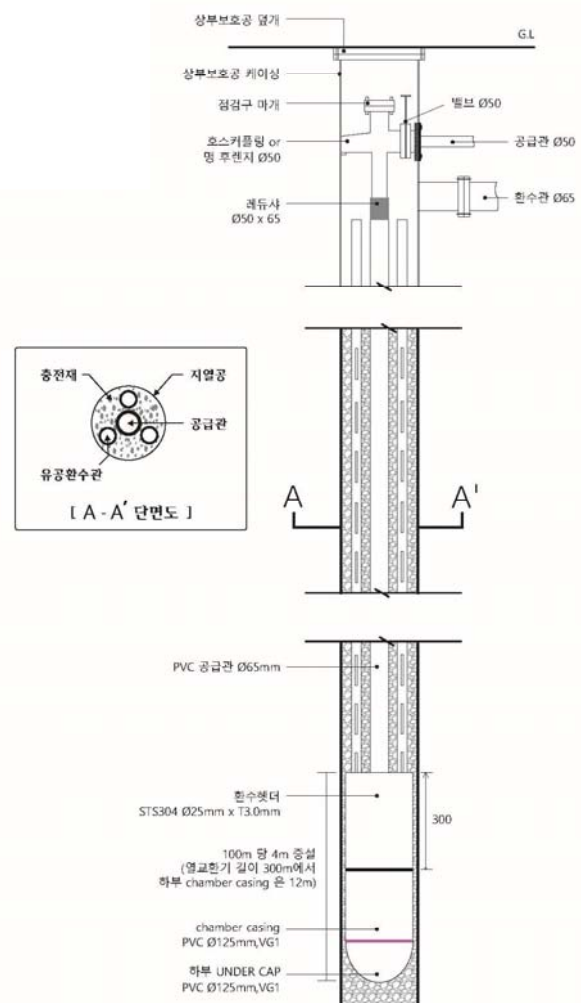
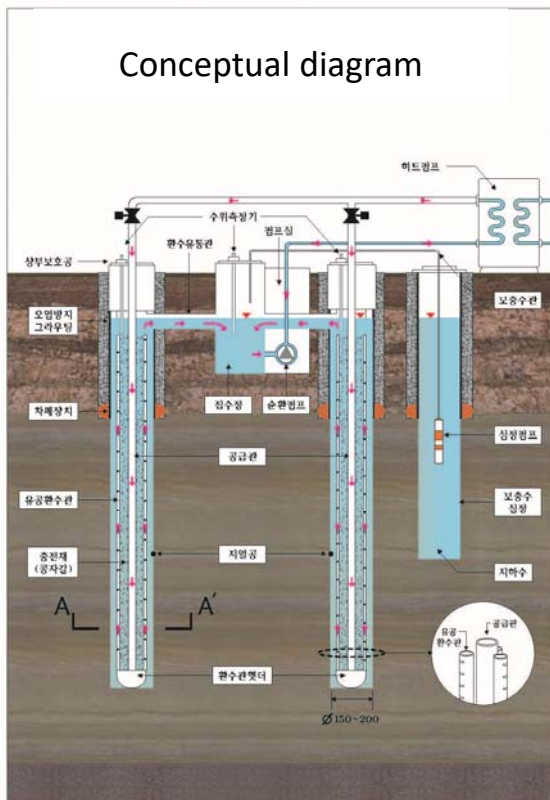

Open loop geothermal system without groundwater motor pump

- Groundwater motor pump is not installed in geothermal well
- Supply and return pipes installed in geothermal well

Can be installed under building

- Because there is no groundwater motor pump in geothermal well
- Large geothermal system can be installed even in narrow areas

Reduced construction costs by up to 50% (at Smart Farm)

- Geothermal well depth(200m) → reduced construction costs
- Same heat exchange capacity to open loop system(SCW)
- Reduced number of geothermal well versus vertical loop system

For 500 usRT

Category	GeoSSum Hybrid	Open loop(SCW)	Vertical loop
Depth (m)	φ200 x 200	φ200 x 500	φ150 x 200
Length of Geothermal well (m)	10,000	10,000	34,000
# of Geothermal well (ea)	50	20	170
# of Motor pump	1 set	20 set	1 set
Operating Cost	low	high	Low
Construction Cost	Low (half of SCW)	high	high

Prevent the inflow of pollutants

- Prevent using the upper protector

Prevent the leakage of brain

- Extends ther supply pipe to the bottom of Geothermal well
- Return pipes connects to the upper protector → Fundamental blockage of brain leakage

Easy maintenance

- Use single motor pump in water tank(per 1zone)
- Possible to reduce operating costs



Model	Diameter (mm)	Depth (m)	Heat capacity (R/T)
GH - 150	200	150	7.5
GH - 200	200	200	10.0
GH - 300	200	300	15.0
GH - 500	200	500	25.0

Groundwater contamination prevention facilities
for Clear and Clean Groundwater,
Geothermal Energy System

(주)지앤지테크놀러지

(21990) 인천광역시 연수구 송도미래로 30
송도 BRC 스마트밸리 지식산업센터 A동 102호·103호

TEL 032,812,0777 FAX 032,812,8333

e-mail dsgweac@chol.com <http://www.pgu.co.kr>



신기술인증



신기술인증



대우엔지니어링



국무총리표창



토양지하수분야대상



건설기술경연대상



조달청우수제품



Registered
ISO 9001:2000



1004수처리
우수특리대상

INNOBIZ
사단법인 중소기업기술혁신협회